

# 3 ways to mount the Gripzo Tablet Grip

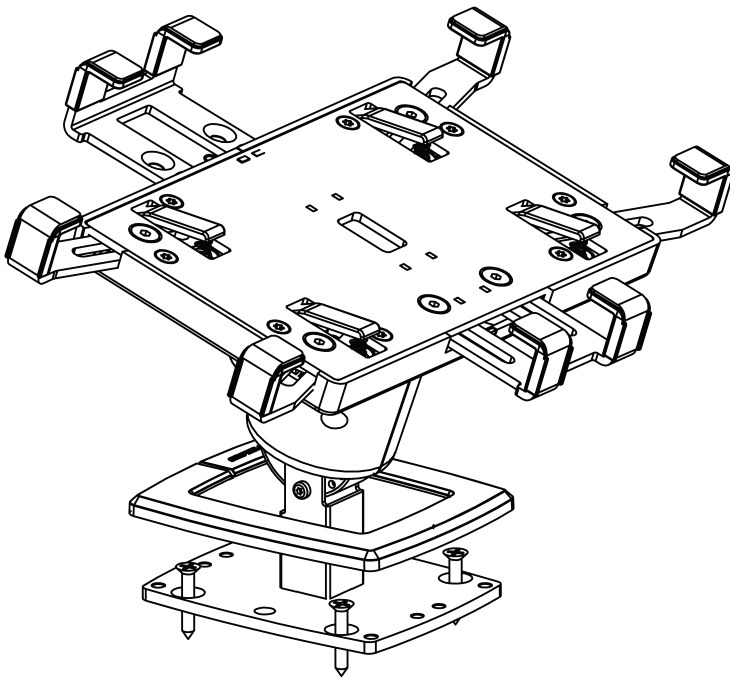

option 1.) Mount the screws through the baseplate

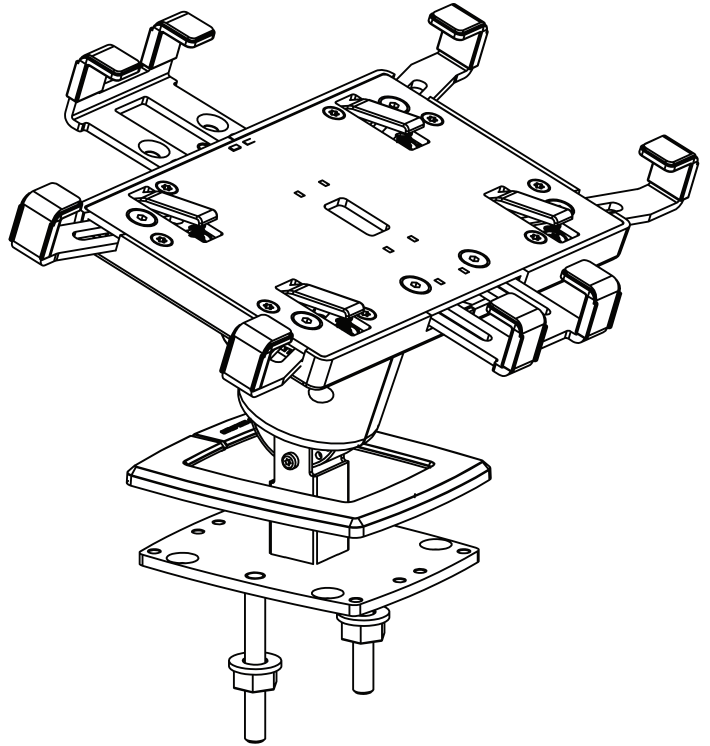

option 2.) Mount the stud/bold from underneath the display table into the baseplate. Secure with a screw / nut

Note; make sure the bolts are level with the top of the baseplate and not through the baseplate

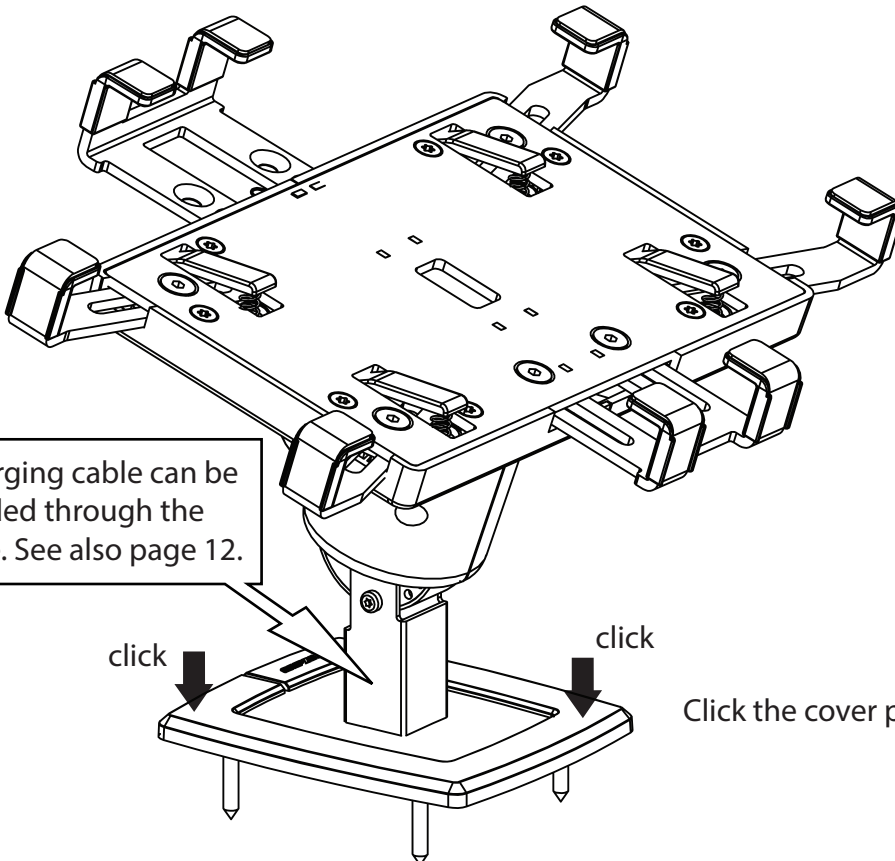

option 3.) Mount with strong self-adhesives in case drilling is not possible (e.g. on glass displays)

NOTE: Nuts & studs, strong adhesives and security screws are not included. These can be ordered as an accessory.

Click the cover plate on

# correct using the Gripzo Tablet Grip

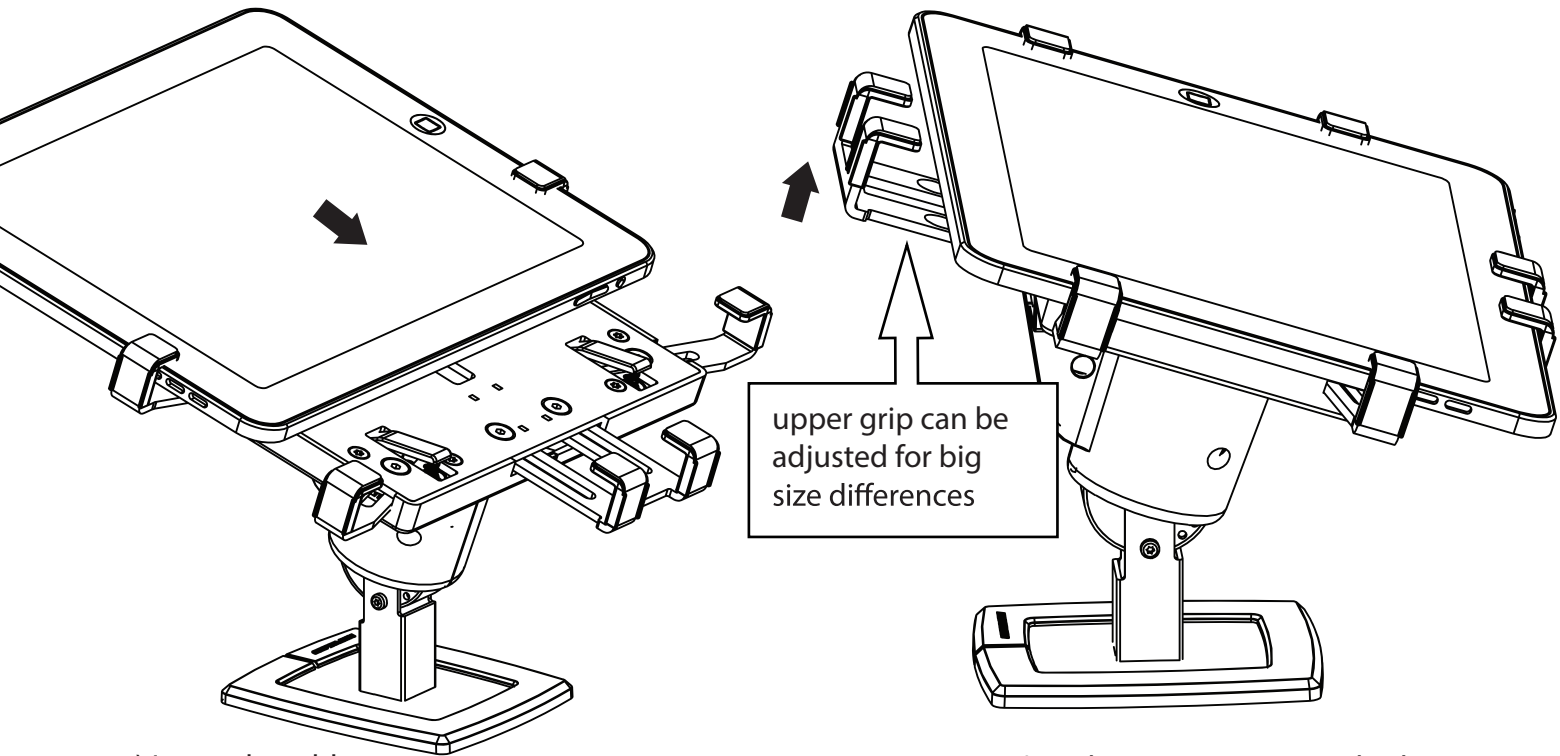

1.) Insert the tablet

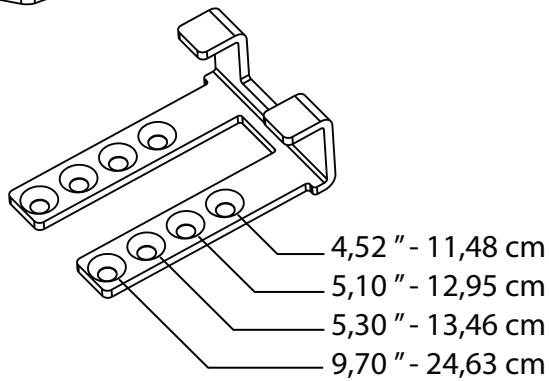

2.) Push upper grip upwards; the individual grips of the upper grip must touch the topside of the tablet for correct functionality. If the grip does not cover the tablet, adjust the upper grip for rough tuning or lower grip for fine tuning (Allen key wrench)

**IMPORTANT!:** do not fit the tablet too tight within upper grip. Upper grip should always close easily with a little space between device and grip  $\leq 2$  mm

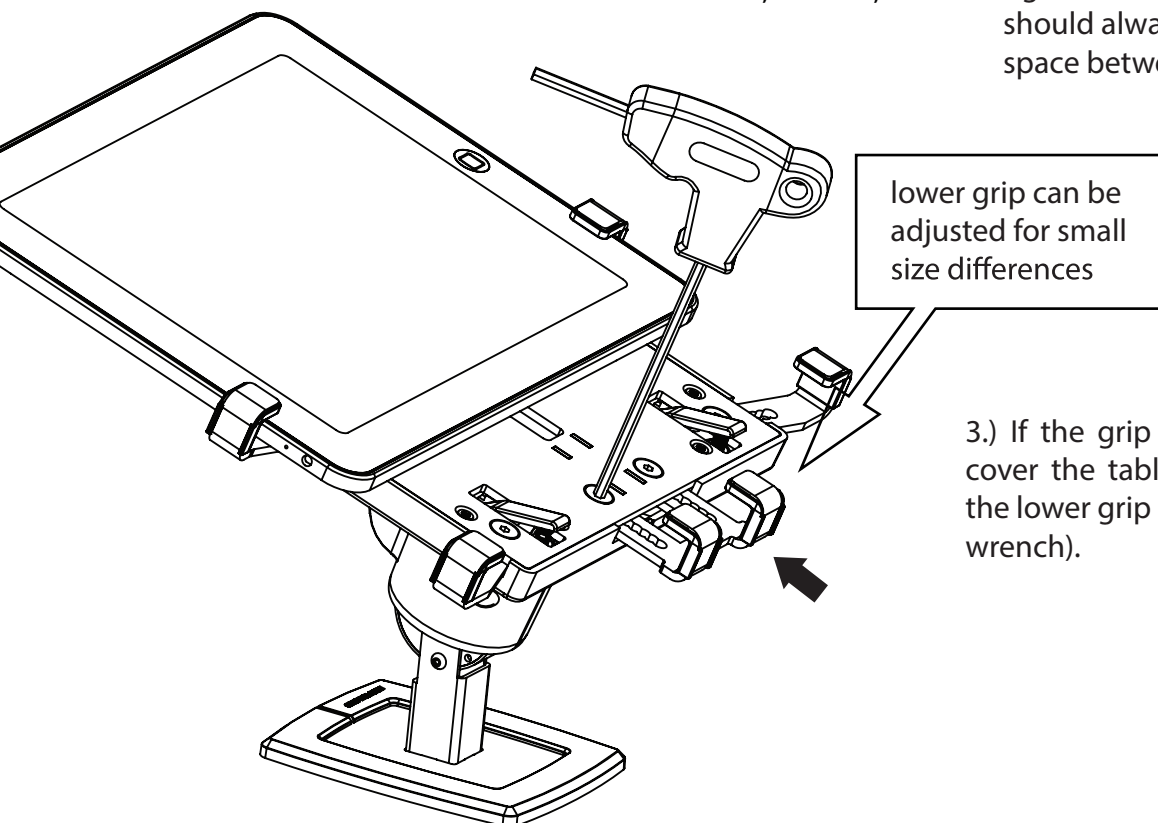

3.) If the grip does not cover the tablet, adjust the lower grip (Allen key wrench).

# correct using the Gripzo Tablet Grip

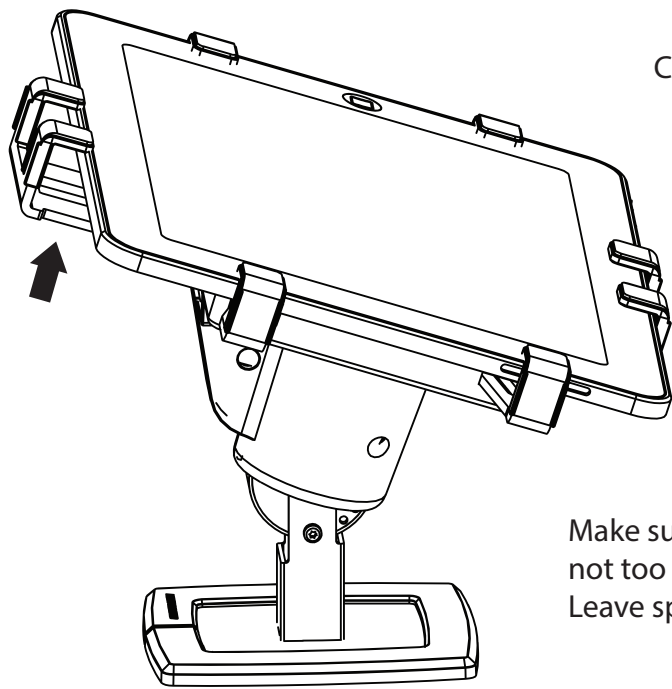

Click!

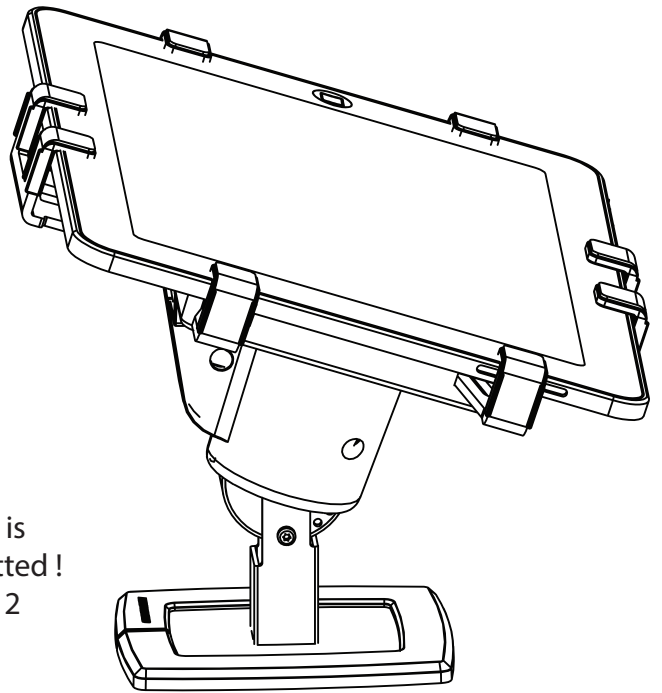

Make sure tablet is not too tightly fitted!  
Leave space of  $\leq 2$

4.) Check again if individual grips will cover the tablet

5.) Finally close the upper grip, and check if the lock is functioning properly and the tablet is locked

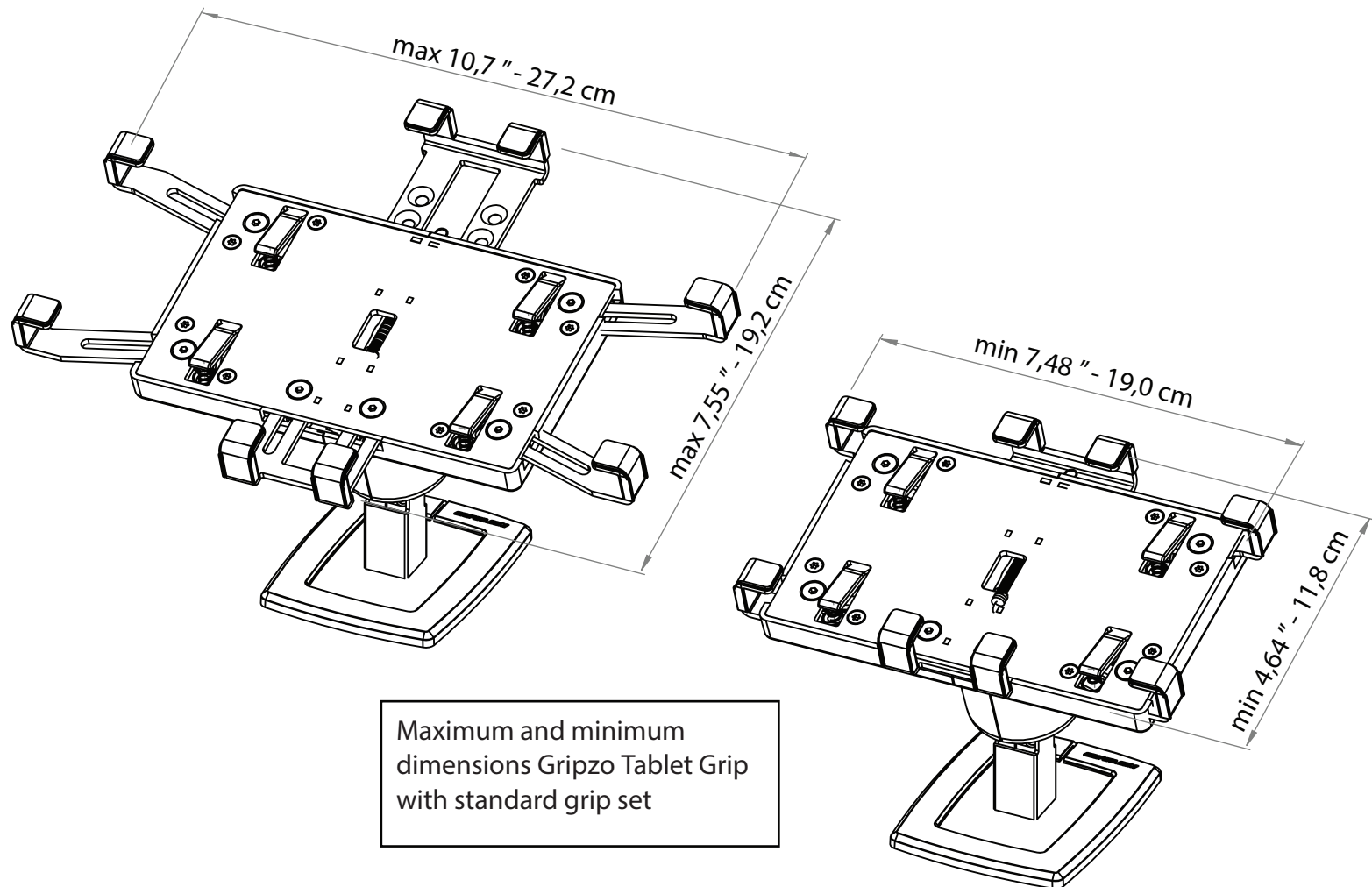

## correct using the Gripzo Tablet Grip

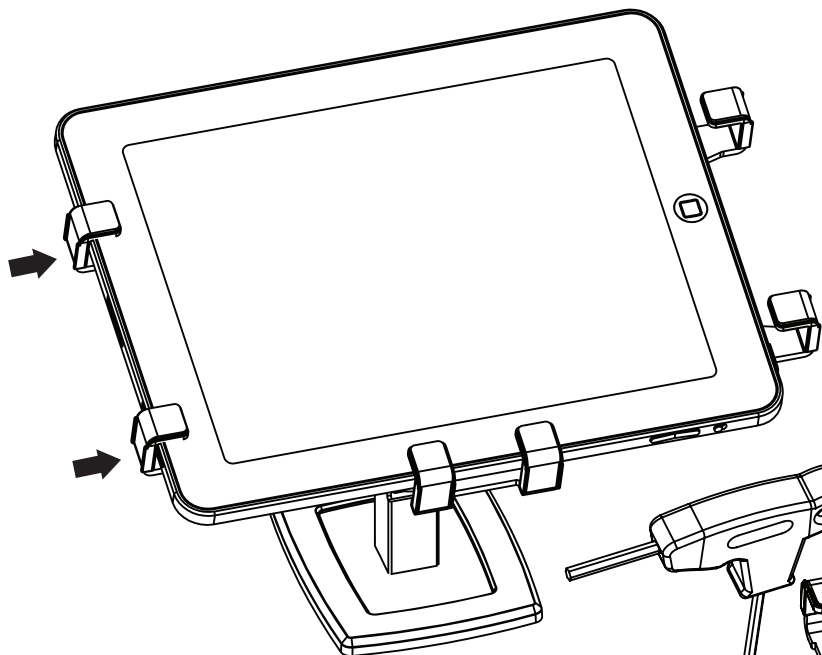

6.) Adjust the side grips with Allen key wrench #3 (not too tight!)

Remove Allen screw completely to adjust grip.

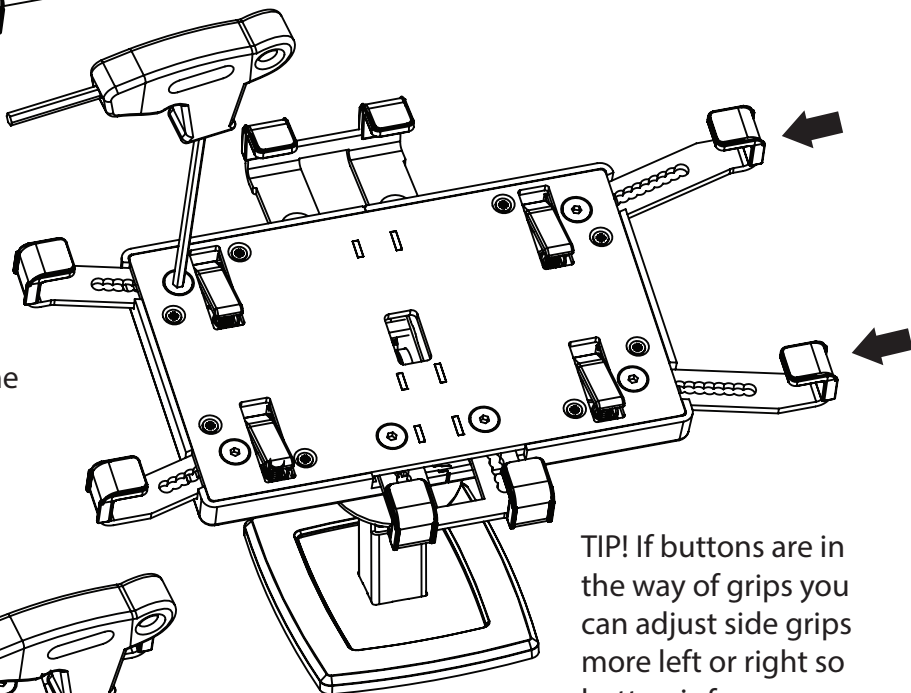

7.) Adjust left and right the same so device is in the center.

TIP! If buttons are in the way of grips you can adjust side grips more left or right so button is free.

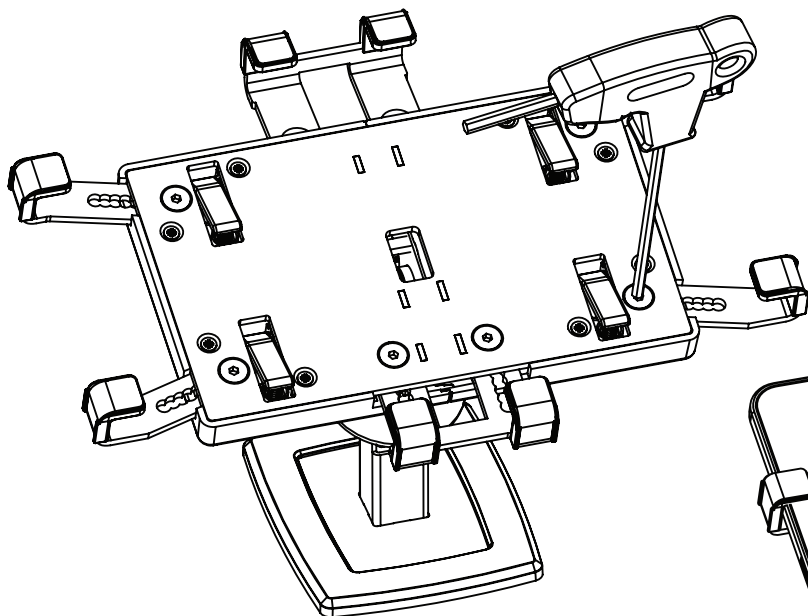

8.) Check Allen bolts and DO NOT screw too tight

9.) Insert the tablet

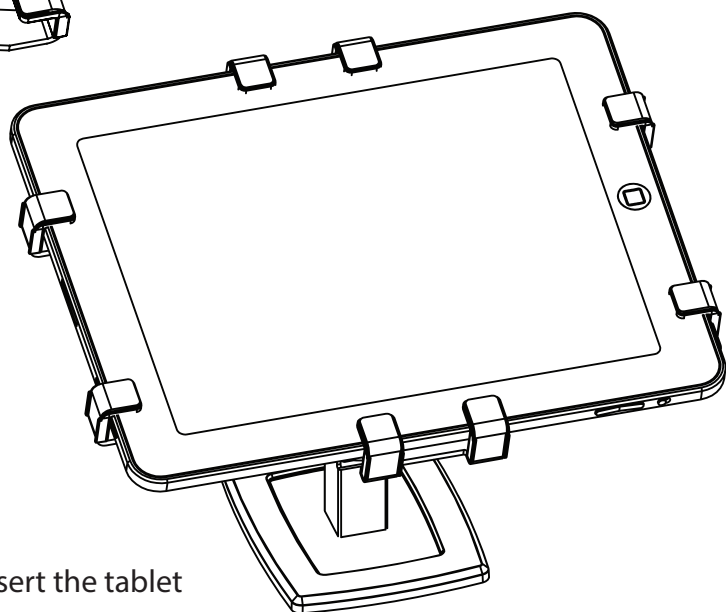

# correct using the Gripzo Tablet Grip

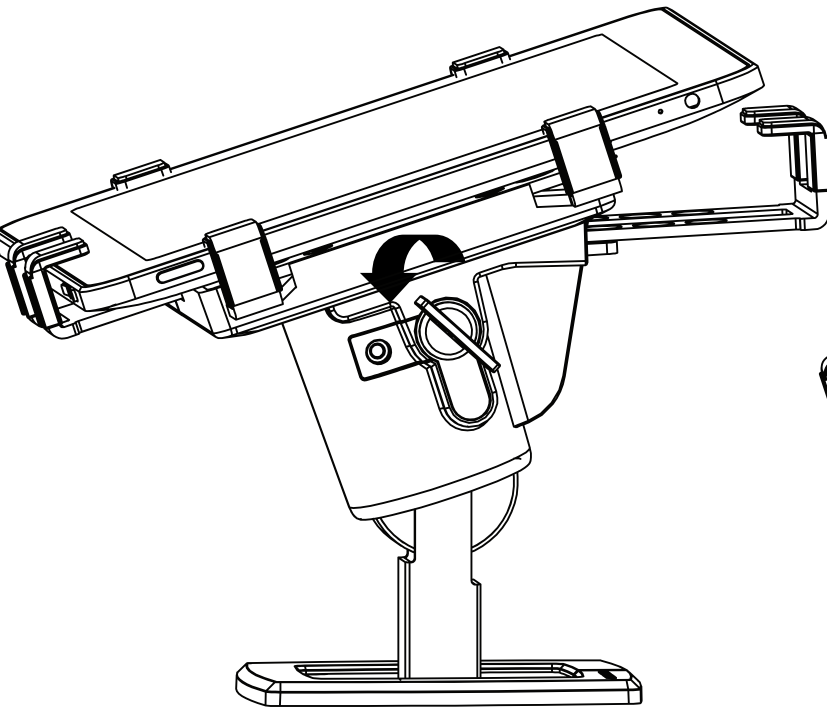

10 a.) Turn the key to the left to unlock

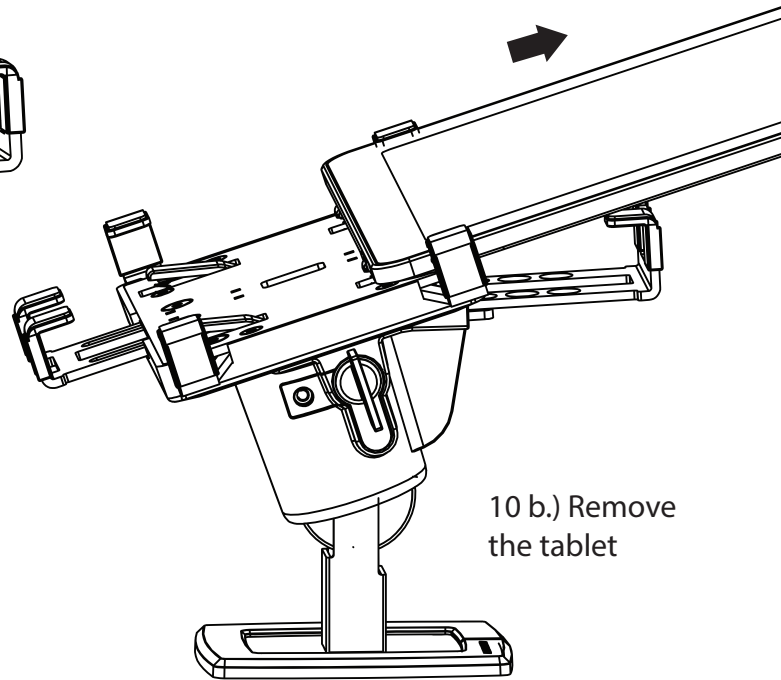

10 b.) Remove the tablet

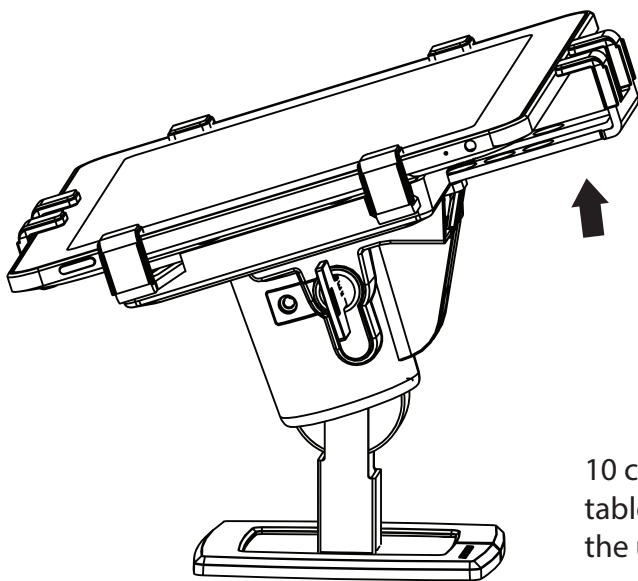

10 c.) Insert the tablet and close the upper grip.

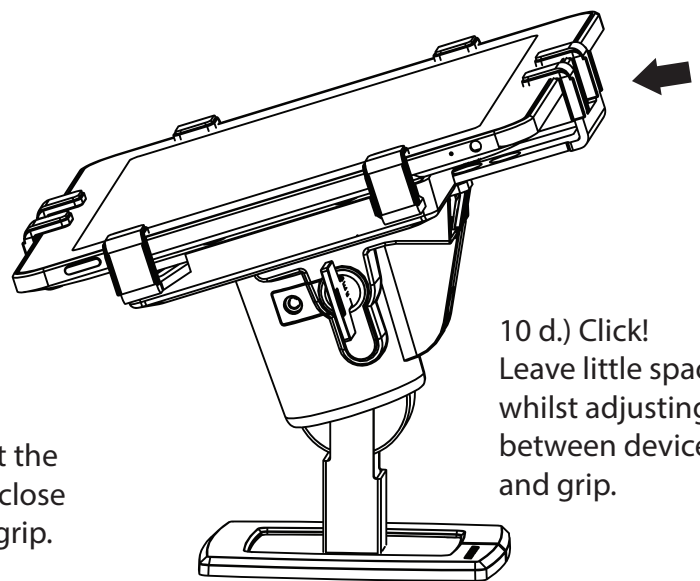

10 d.) Click!  
Leave little space  
whilst adjusting  
between device  
and grip.

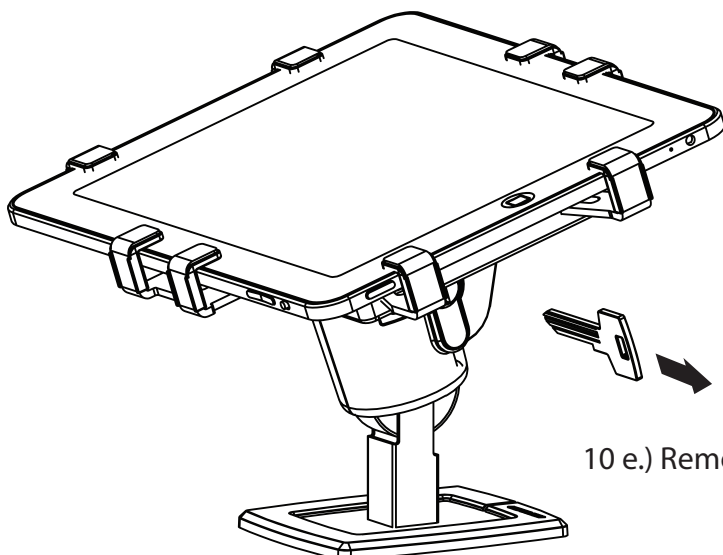

10 e.) Remove the key.

tablet thickness 3 - 10 mm

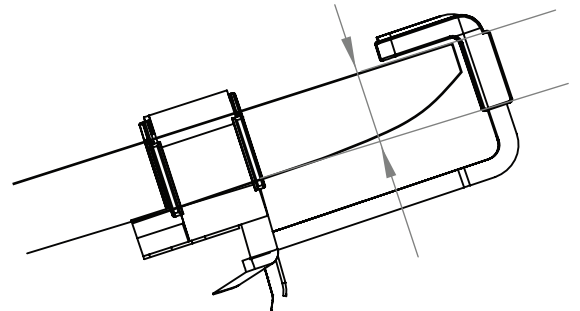

# changing the display angle

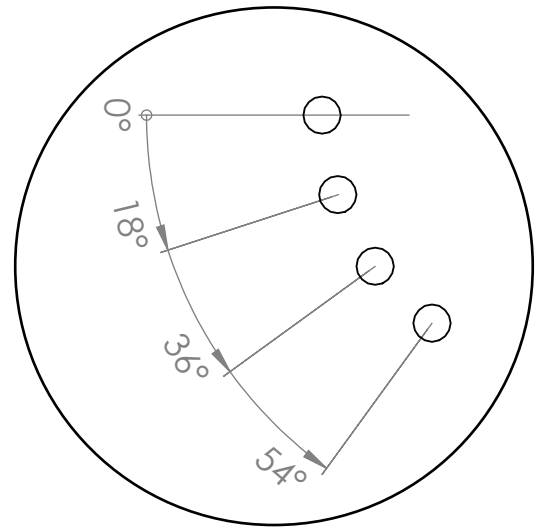
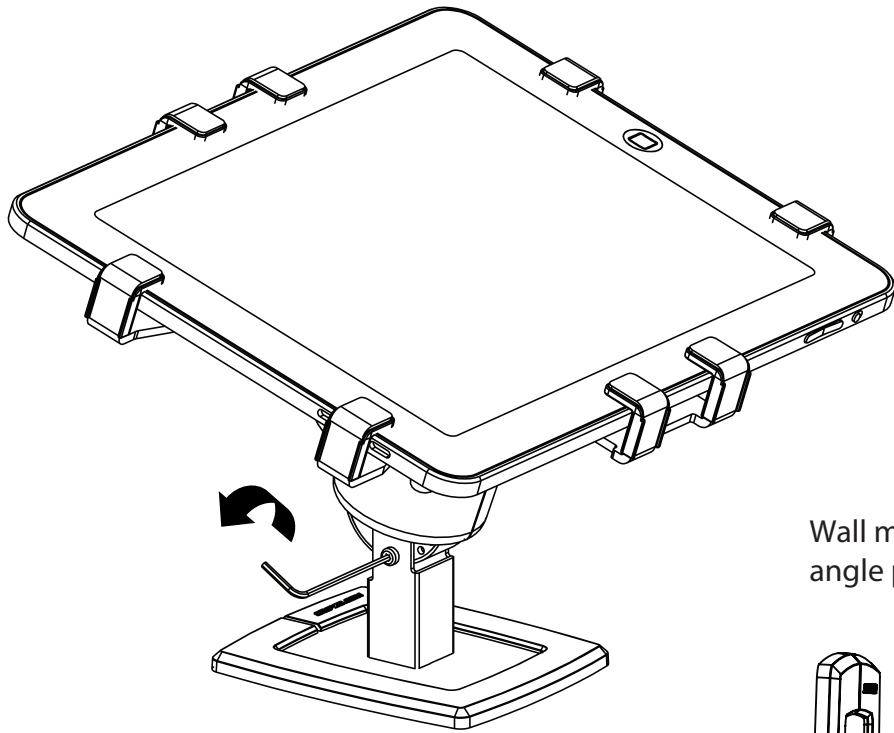

Wall mount adjustment angle position is parallel to wall

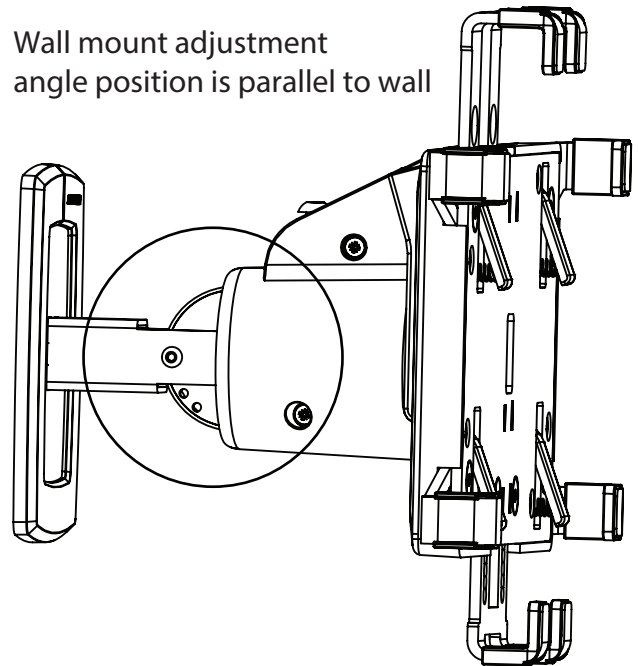

1.) Loose the screw on the pole with an Allen key (2 mm)

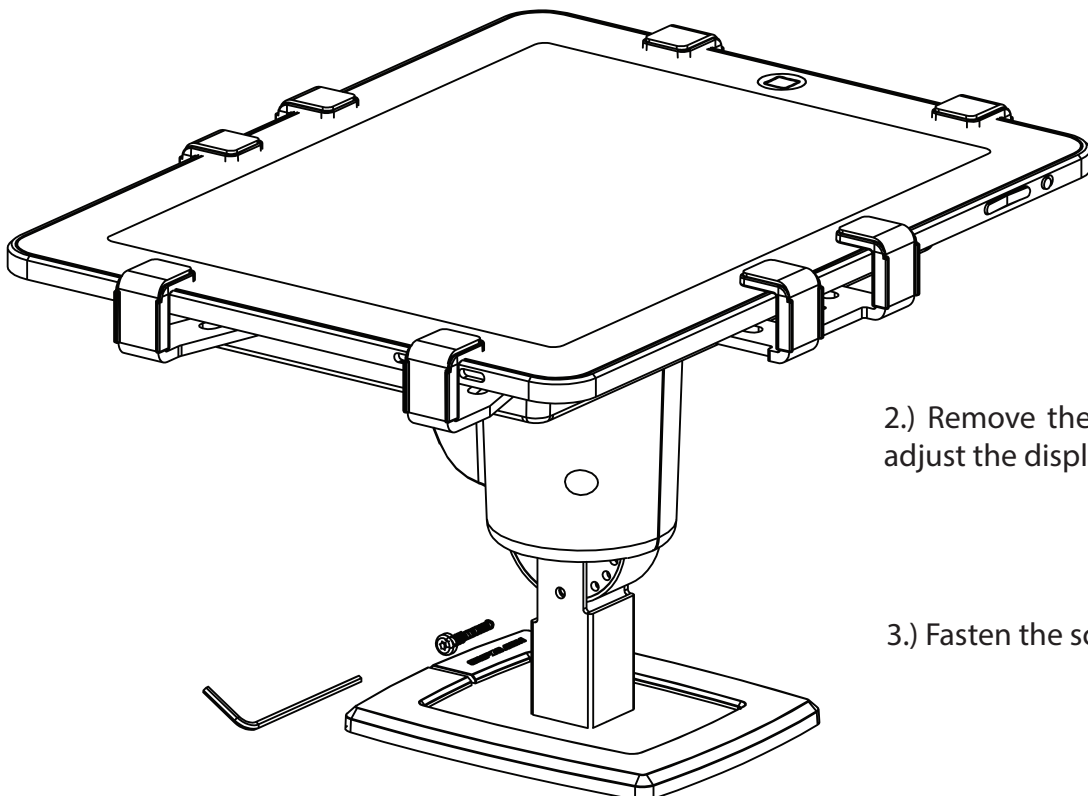

2.) Remove the screw to adjust the display angle

3.) Fasten the screw

## changing the lock

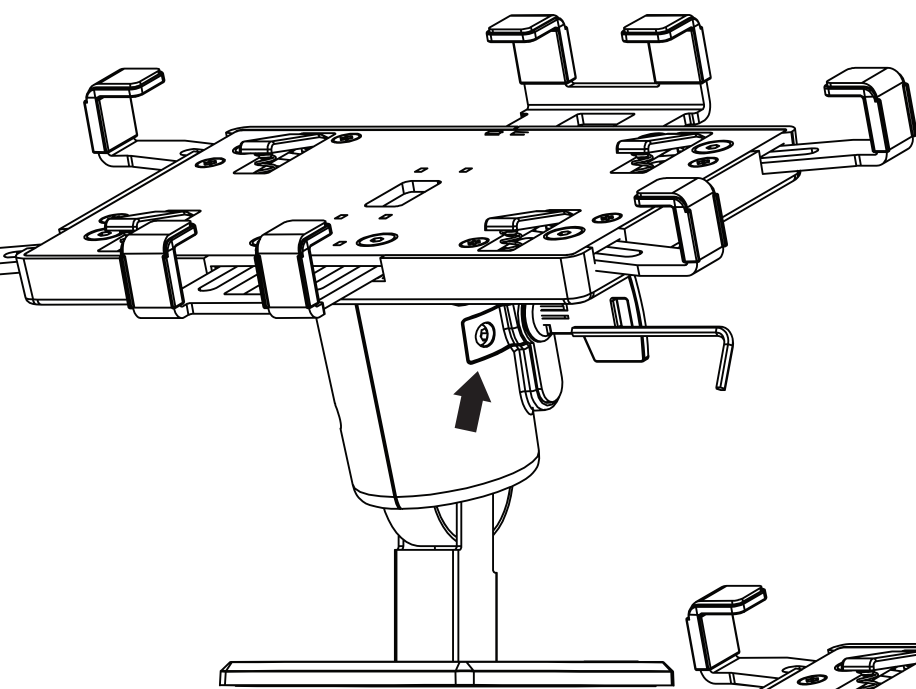

1.) Remove the cap with an Allen key (2 mm)

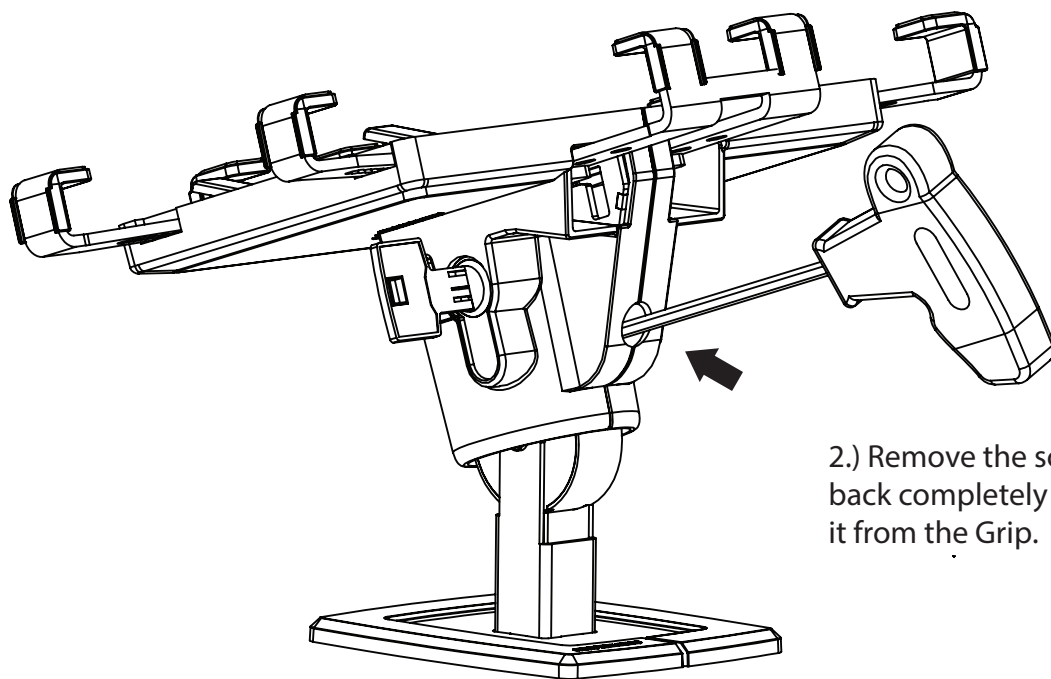
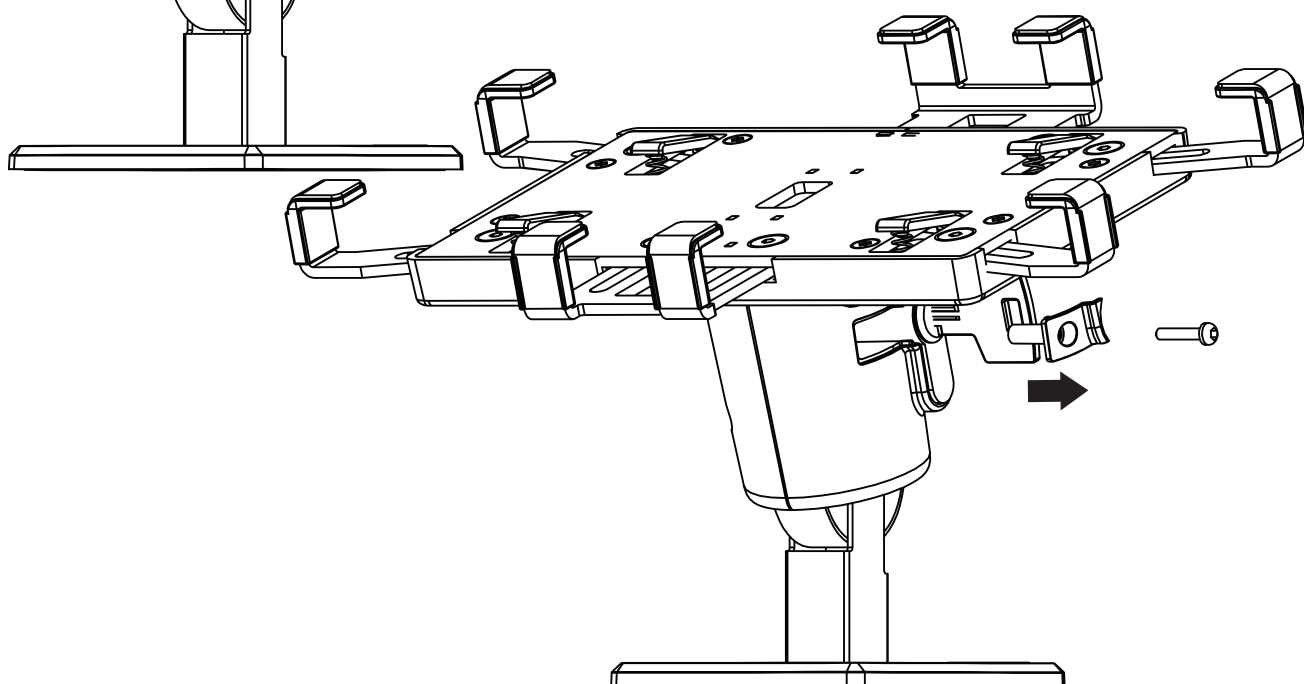

2.) Remove the screw in the back completely and remove it from the Grip.

# changing the lock

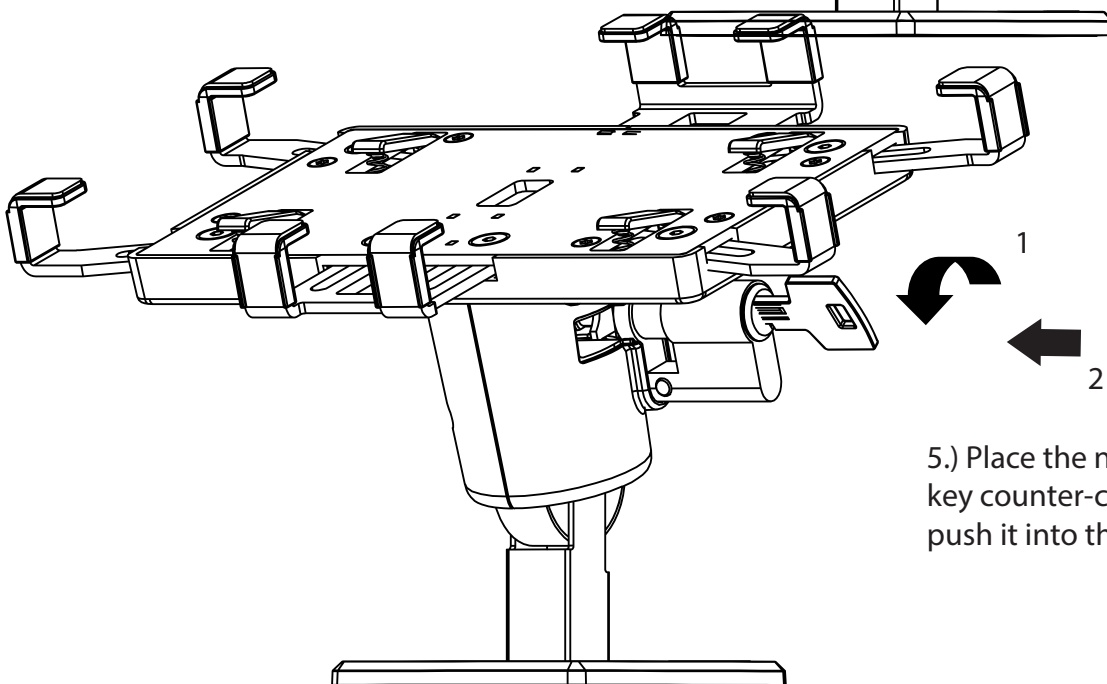
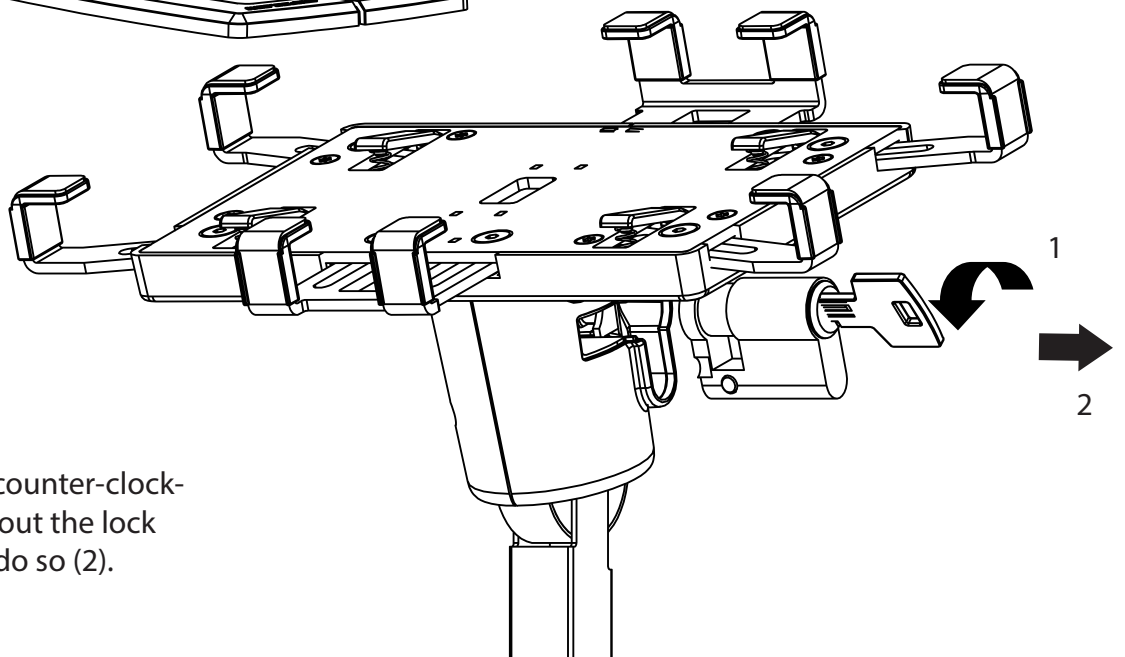
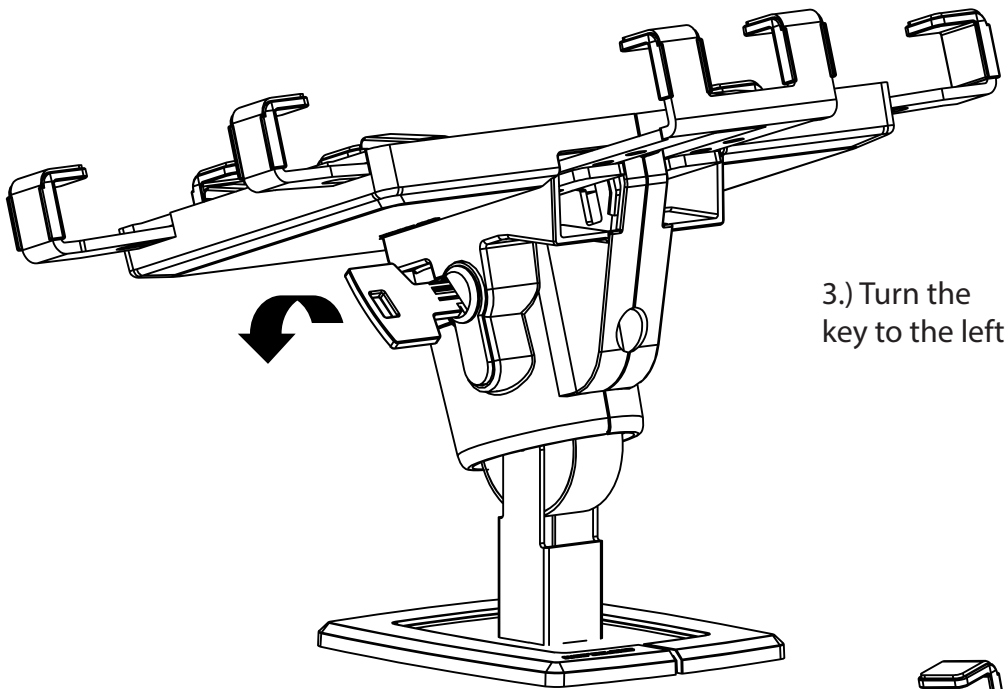



securing the lock thus guaranteeing smooth lock/key operation

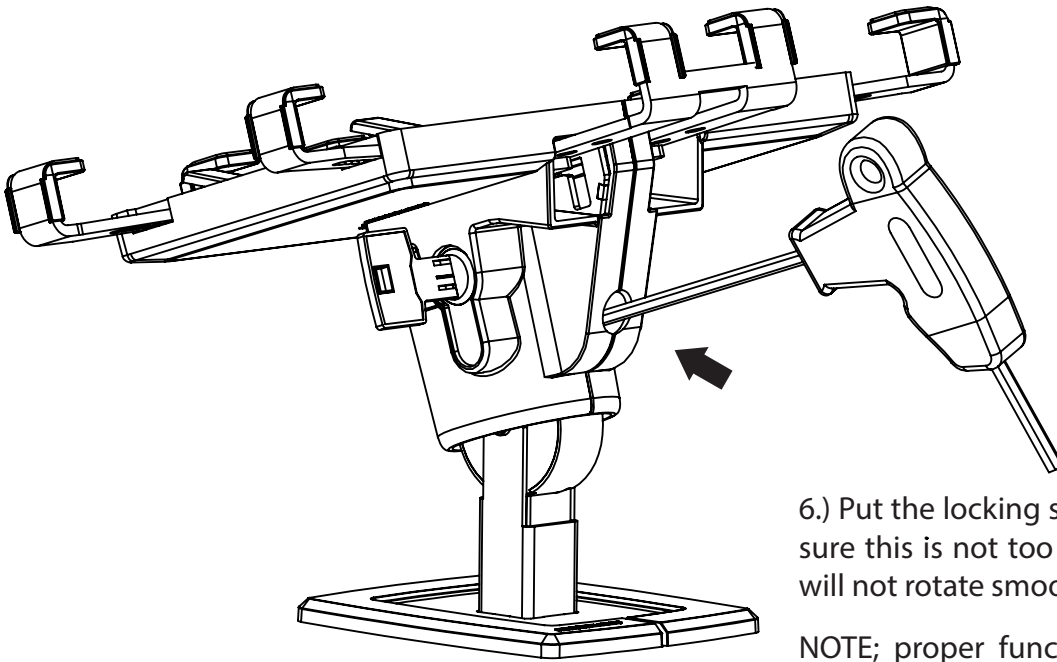

6.) Put the locking screw into the lock, make sure this is not too tight otherwise the lock will not rotate smoothly.

NOTE; proper function of the lock is very important for a correct functioning of the Grip.

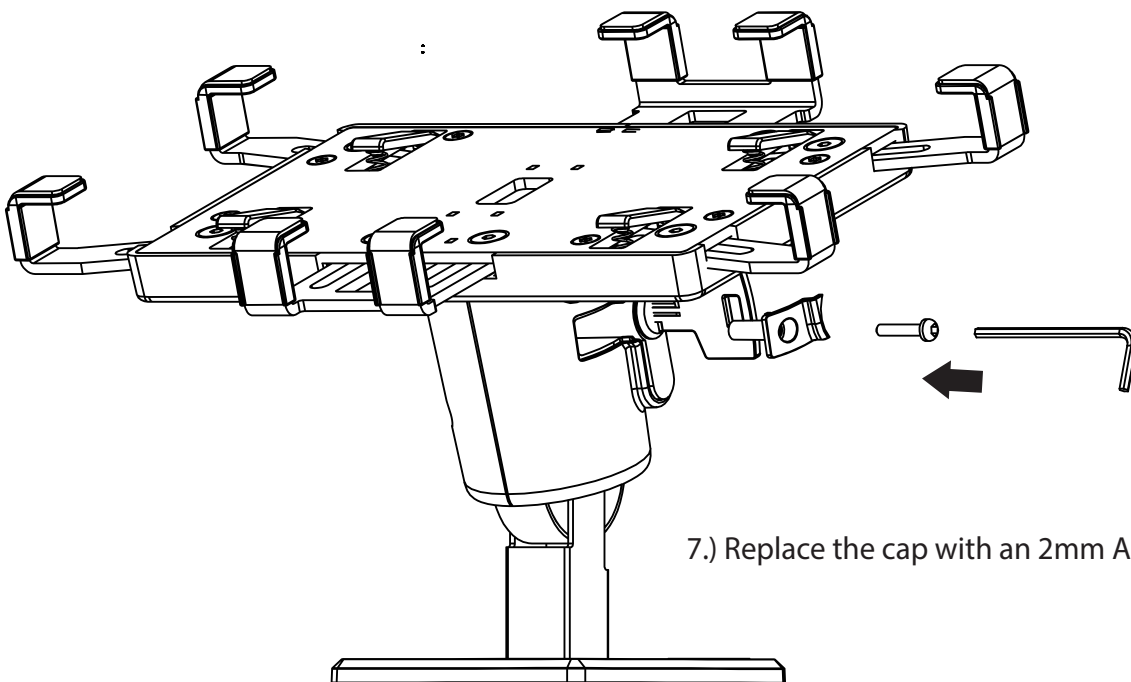

7.) Replace the cap with an 2mm Allen key / wrench

# changing the lock Tablet - Smartphone

It is possible to exchange the lock from Tablet to Smartphone holder and vice versa. In that case notice that the cams is positioned correctly.

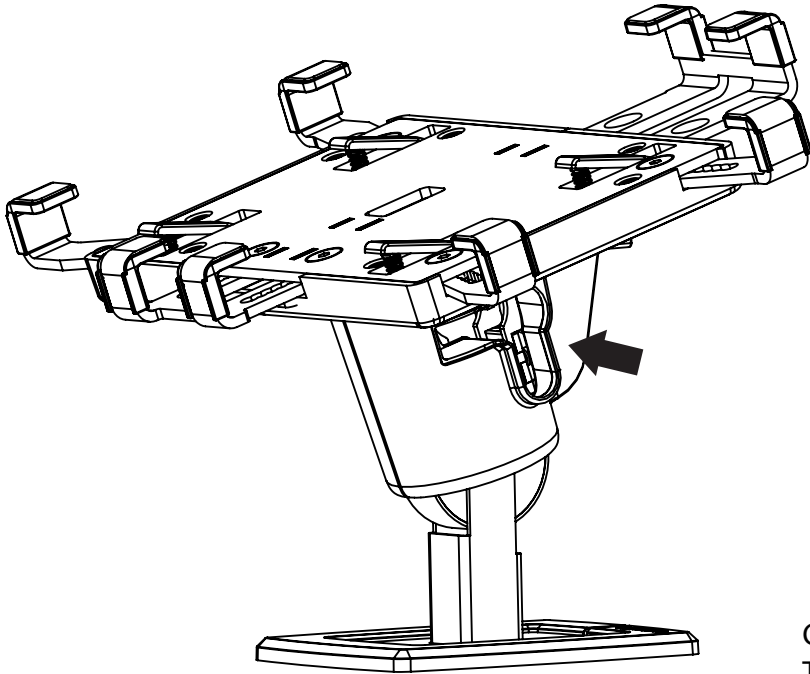

1. push the pin downwards

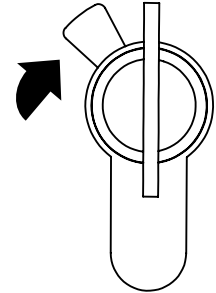
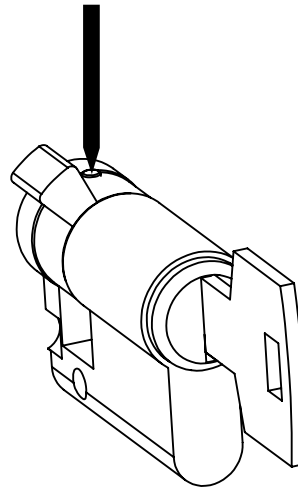

2. rotate cams to 11:00 o'clock.

Cams position for Gripzo Tablet Grip and POS Grip

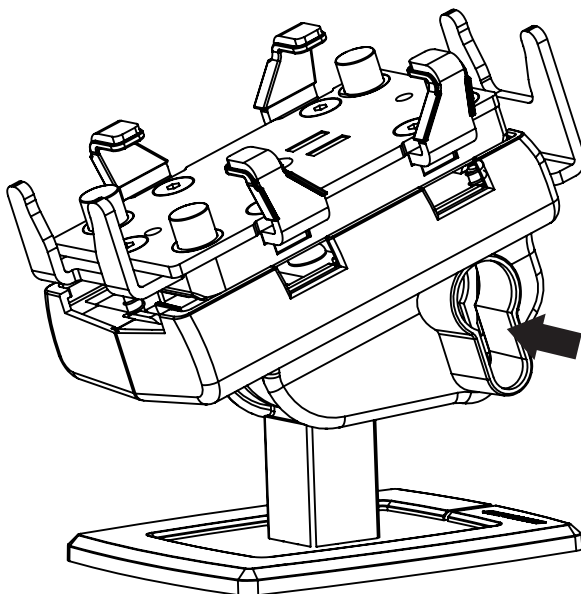

1. push the pin downwards

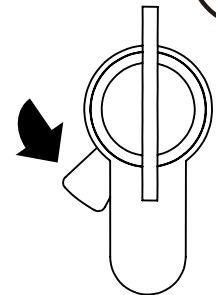
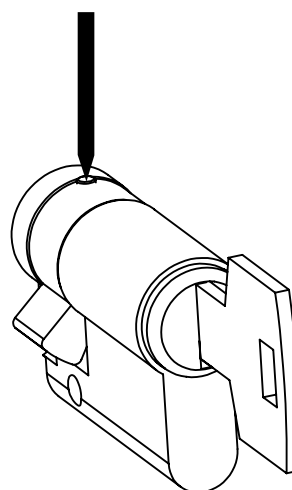

2. rotate cams to 7:00 o'clock.

Cams position for Gripzo Smartphone Grip

# changing standard grips for an XL gripset

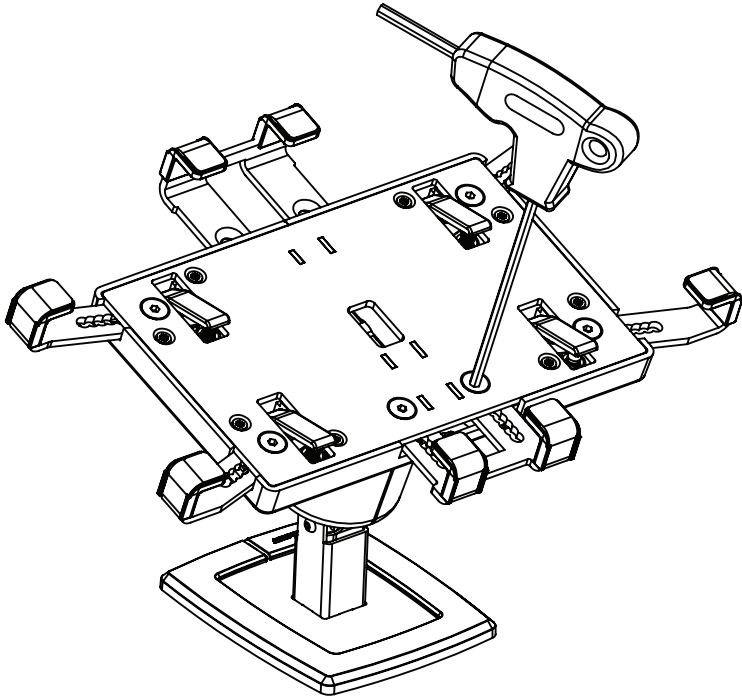

1 ) unscrew the bolts completely and remove the grips.

2 ) option 1: change lateral undergrip by its XL version (to optimize centralised position of the tablet; or better position of grips with respect to buttons of the tablets)

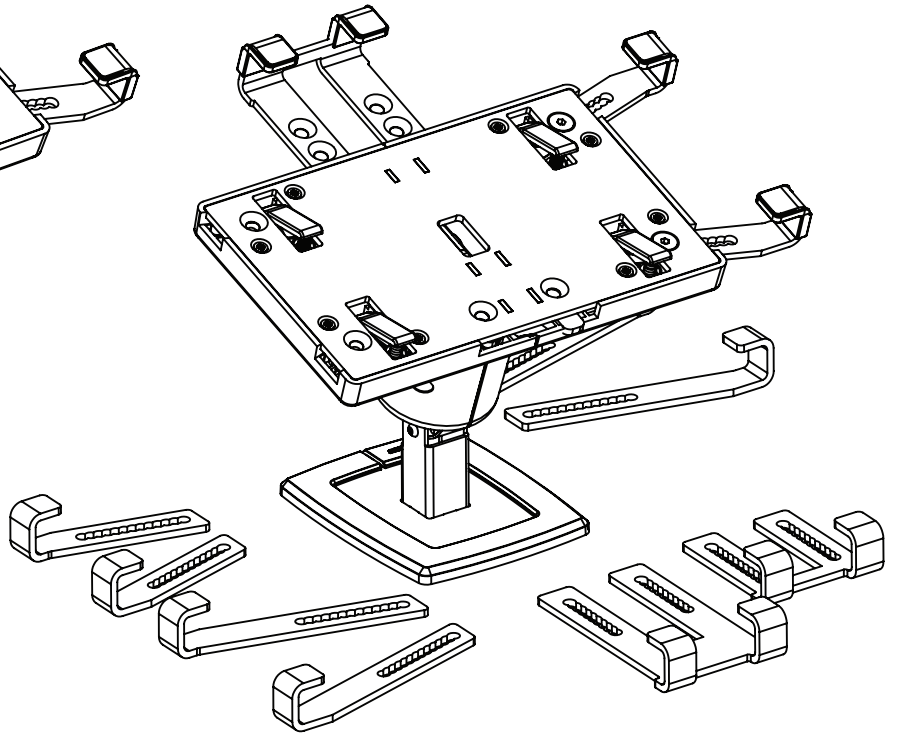

3 ) option 2: change all grips by the XL version of these grips.

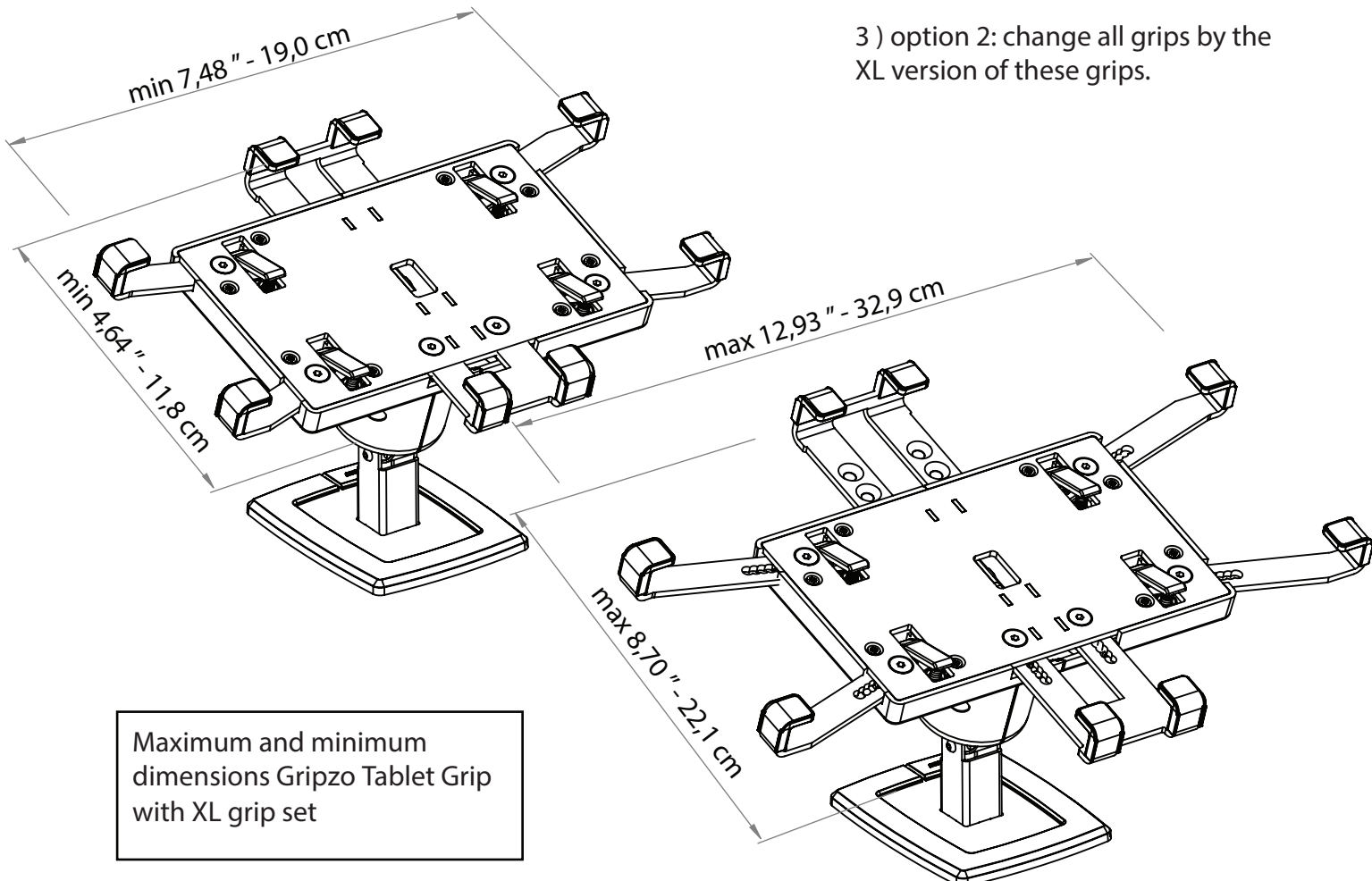

Maximum and minimum dimensions Gripzo Tablet Grip with XL grip set

# implement chargingcable

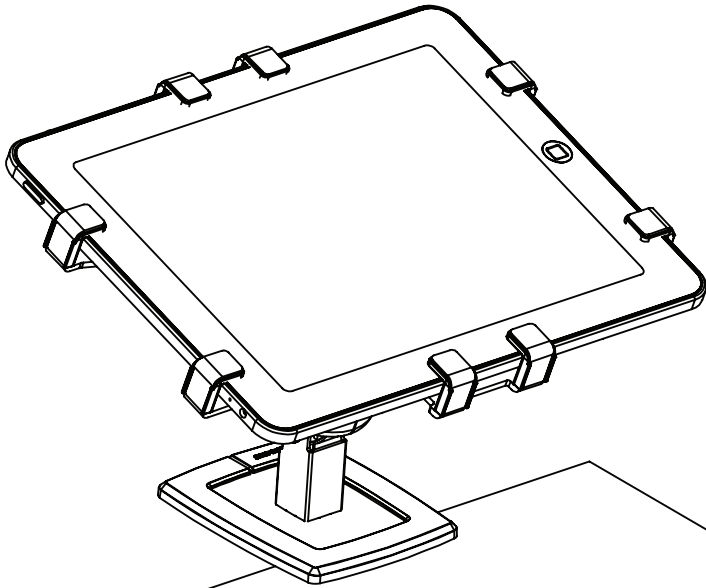

1.) Lead charging cable through cable entry hole in the display table

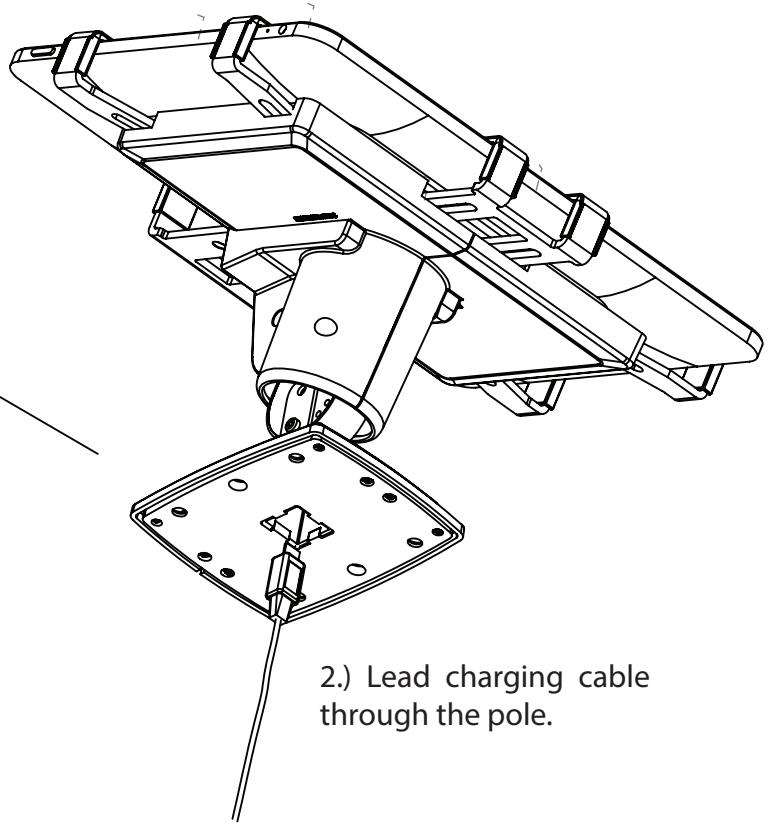
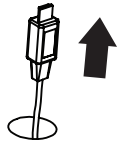

2.) Lead charging cable through the pole.

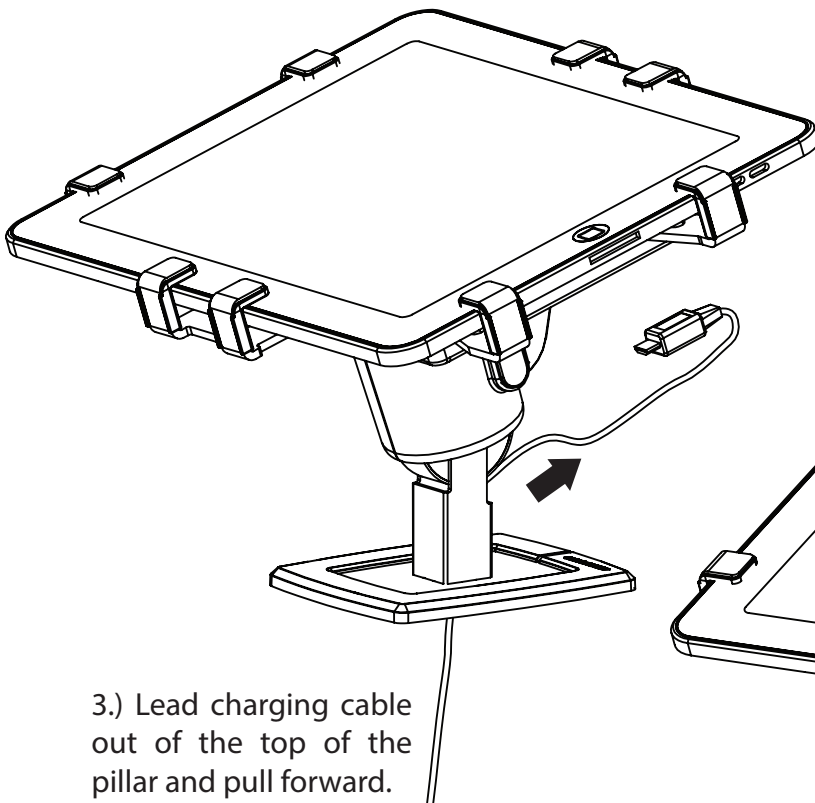

3.) Lead charging cable out of the top of the pillar and pull forward.

Thereafter, mount the grip to the display table.

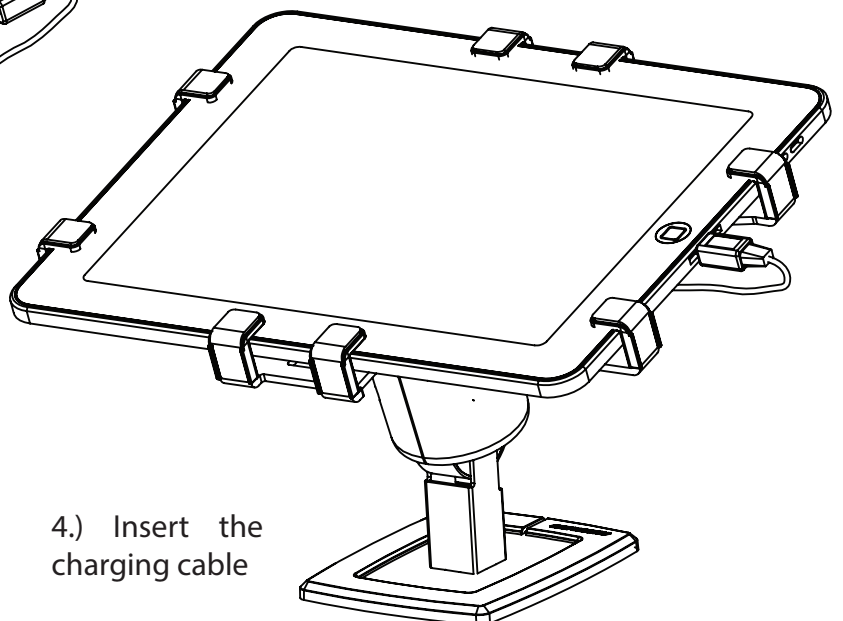

4.) Insert the charging cable

# Swivel and Rotation functionality

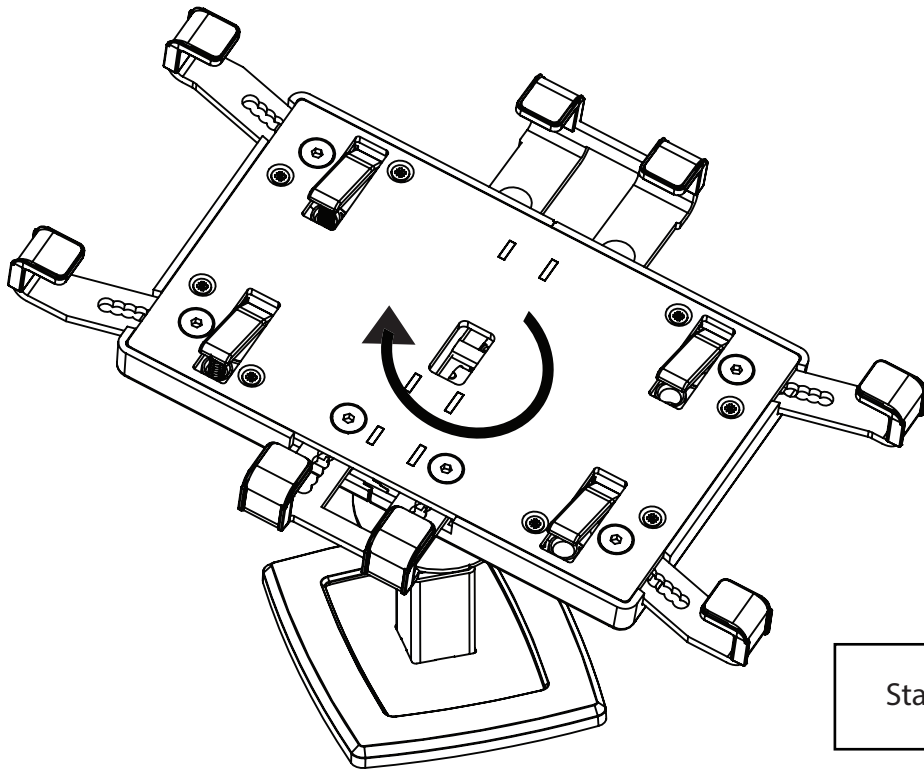

The standard tablet grip can rotate over 90°; portrait to landscape position.

Standard tablet grip

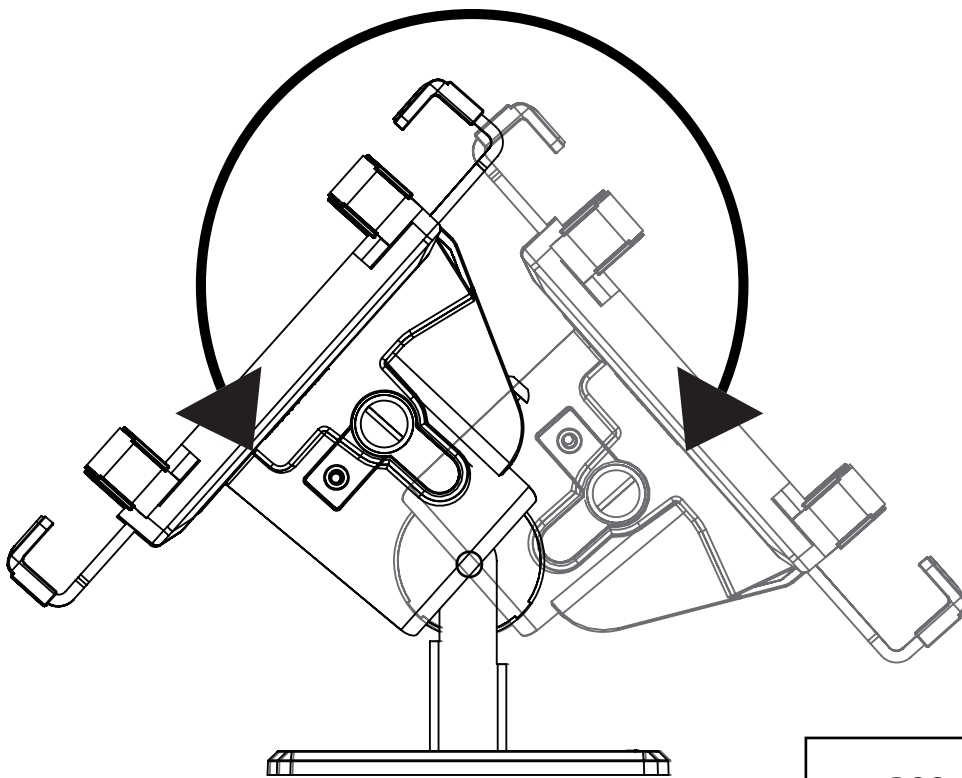

The POS tablet grip can swivel over 150° as well as rotate from portrait to landscape.

POS tablet grip